



Making Your Life Better.

BU Medical Equipment

**Sede legale ed amministrativa
Headquarters**

Cefla s.c.
Via Selice Provinciale, 23/a
40026 Imola - Bo (Italy)
tel. +39 0542 653111
fax +39 0542 653344

**Stabilimento
Plant**

Via Bicocca, 14/c
40026 Imola - Bo (Italy)
tel. +39 0542 653441
fax +39 0542 653601



CART.

ANTHOS SURGICAL CART



SPECIALIST TREATMENT



A concentrate of technology

IMMEDIATE IMPLEMENTATION

The Surgical Cart is today's most versatile solution for the immediate implementation of endodontic and implantology treatment; all that's needed is a patient chair, without any requirement for a unit body or further stand-

alone modules. One Cart - which can be coupled to two connection boxes installed in different rooms in the surgery - can provide two specialist treatment workstations. More potential, less investment.



Clinical performance.

Designed to house specific implantology/endodontics instruments, applications and software - reciprocating mode included - the Surgical Cart boosts the practice's potential to receive patients, even in rooms without an equipped dental unit. In the optional configuration that links a Cart to more than one floor-mounted connection box, dentists can optimise treatment planning by moving the equipment from one room to another.

NFC connectivity.

The Cart also features the option of NFC connectivity. The system has a microchip integrated on the Cart and an IP68-rated silicone NFC bracelet. This practical, light, easily sanitised bracelet is brought up to the side of the tablet with the NFC symbol: the Cart instantly recognises the dentist and the software applies the settings he/she previously saved during registration. Useful in multi-user practices, the system has 20 memory slots (i.e. for up to 20 dentists). Users can save personalised settings for integrated instruments and set interface preferences. Every time the dentist brings the bracelet in close and connects to the Cart, the system recalls all the saved personalised settings.



Touch screen display.

The easy-to-read 7" screen controls various functions and specialist instruments. The protective glass is impact and water-resistant and can be disinfected easily and safely.



Full Touch control panel.

Available in two versions - Clinic (as standard) and Multimedia (optional) - the control panel lets users personalise parameters on the integrated devices. On the Multimedia version it can also control the torque curves.

Images and video.

The Multimedia control panel lets users play clips and see images and X-rays contained on USB devices. Further graphics designed to provide support during treatment procedures can also be displayed.

USB.

A convenient USB port lets individual dentists save and download their personalised settings, a feature that's extremely useful in surgeries with two dentists or more. Moreover, it lets users export torque curves (function available in surgical mode).

Integration and freedom

IMPLANTOLOGY

In addition to providing a complete package of instruments and services for implantology, the Surgical Cart lets dentists perform treatment wherever the connection box is installed (optional rapid coupling required). In the standard configuration (one Cart for each connection box, no rapid coupling), a patient chair

will suffice, even if there is no unit body or instrument module.

Featuring dedicated programmes accessible in IMPLANT mode via the control panel, the software lets users control the micromotor and peristaltic pump; it also lets them read torque curves and display implant procedure references.



i-MMs micromotor.

Autoclavable and easy to disinfect, the micromotor can reach a torque of up to 70 Ncm and, together with the EVO R20L contra-angle, provides the perfect response to the implantologist's every need. The software allows precise, safe control of speed and torque.



EVO R20L contra-angle.

Designed for implant surgery. Can be removed, autoclaved and heat-disinfected. Features internal cooling and external spray. LED lighting is powered by an integrated generator.

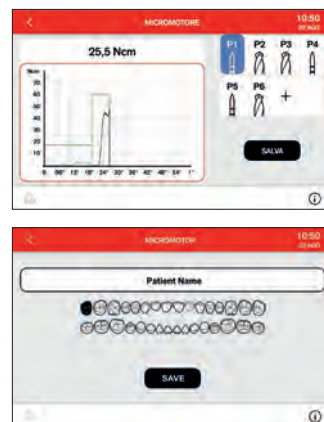

Torque curves.

This function allows constant monitoring of the torque delivered by the micromotor and provides a complete report on each stage of treatment.

Exportable via USB stick: the .csv format is used for academic assessment, the PDF provides a document to be kept in medical records and the .png file is perfect for fast viewing on the Multimedia display.

The clinical information highlighted by this function aids subsequent treatment on adjacent or contralateral teeth. Moreover, implant tightening torque is recorded as it may be included in the surgery documentation.



Peristaltic pump.

Controlled via the panel, the peristaltic pump ensures sterile irrigation of the surgical handpieces.

Advanced features

ENDODONTICS

The Surgical Cart mounts a comprehensive system of endodontic treatment applications. In addition to the micromotor, an integrated database of suitable contra-angles and endodontic files, Autostop-Autoreverse-Autoforward functions and an electronic apex locator are provided. All of

these can be precision-controlled via the Full Touch panel. Essential data is displayed during treatment, ensuring complete control. The software automatically sets torque and speed; alternatively, dentists can set values according to personal requirements.



i-MMs micromotor.

Light, compact and fully autoclavable. Fine, precise torque adjustment.



Contra-angle.

With a 4:1 reduction ratio, the EVO E4 can be autoclaved and heat-disinfected. A miniaturised head aids access to difficult-to-reach treatment zones.

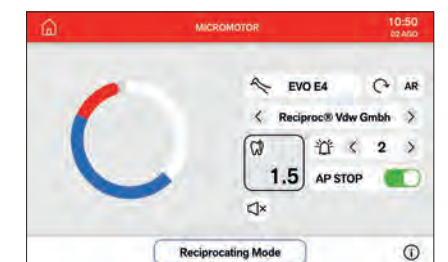
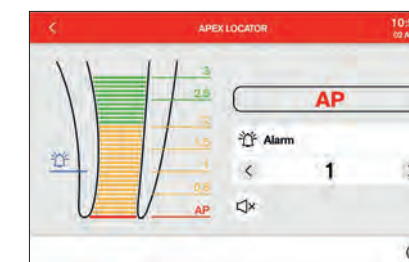
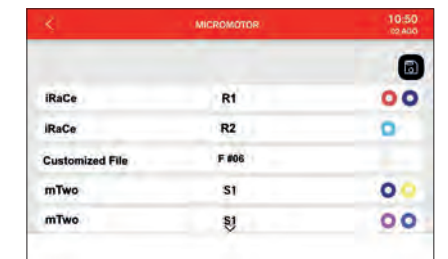
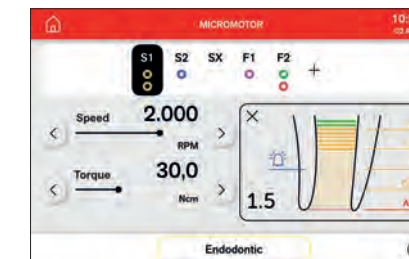

Apex locator.

The apex distance is displayed on the Full Touch display during root canal instrumentation. The nearing of the apex is verified by the ENDO software. Once the apex is reached the Apex-Stop function interrupts micromotor rotation.

Reciprocating mode.

A combination of reciprocating mode (i.e. alternating rotation movement) and the EVO E4 contra-angle allows use of RECIPROC®, RECIPROC BLUE® and WAVEONE GOLD® endocanal files. The endodontic file brand names are not owned by Cefla or any of its subsidiaries.

Evolved instruments

MAXIMUM POTENTIAL

Advanced clinical performance, full integration with electronics, customised operating parameters. A latest-generation microprocessor ensures dentists can control a full range of instruments, simply and precisely.

The turbine, micromotor, scaler and curing light settings can all be adjusted for the specific needs of each type of dental treatment. A curing light can be added as the sixth instrument.

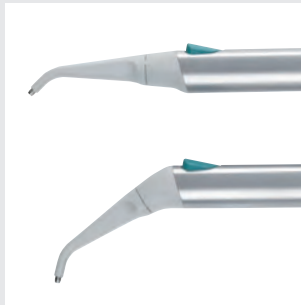

FLUO micromotors.

In addition to improvements that reduce both weight and noise, Anthos micromotors are now available with the option of FLUO micromotors, which feature FIT (Fluorescence-aided Identification Technique) technology to detect any composite materials in the teeth.

Easily visible.

The composite material in the tooth is revealed by the UV LED light. This makes its removal easier, faster and more precise compared to illumination with traditional white LED light.

Micromotors.

Two versions: i-MMr (3.3 Ncm) with LED; i-MMs (5.3 Ncm) with LED lighting, ready for endodontic and implantology treatment. From 100 to 40,000 rpm.

Scalers.

With or without LEDs, handpieces compatible with the best tips on the market. Highly useful in ENDO mode as root canal treatment instruments.

Turbines and contra-angles.

Dentists can use a broad range of turbines and contra-angles for specific dentistry tasks.

Syringes.

Ergonomically-shaped 3 and 6-way syringes are available. The metal syringe body and the tip (both straight and angled versions are available) can be removed and autoclaved.

T-LED.

Maximum ergonomics thanks to the swivel grip. 6 polymerisation programmes and autoclavable fibre optic light guide.

SURGICAL CART



Operating and organisational freedom

FLEXIBILITY

The Surgical Cart is available in two versions, both configurable with the complete system for implantology and endodontics. The as-standard version with connection box integrated on the Cart provides freedom of movement within the

same room. The optional version with plug & play connection - with multiple boxes in more than one room - lets the dentist decide where to connect the Cart according to the planned treatment and move quickly from one room to another.

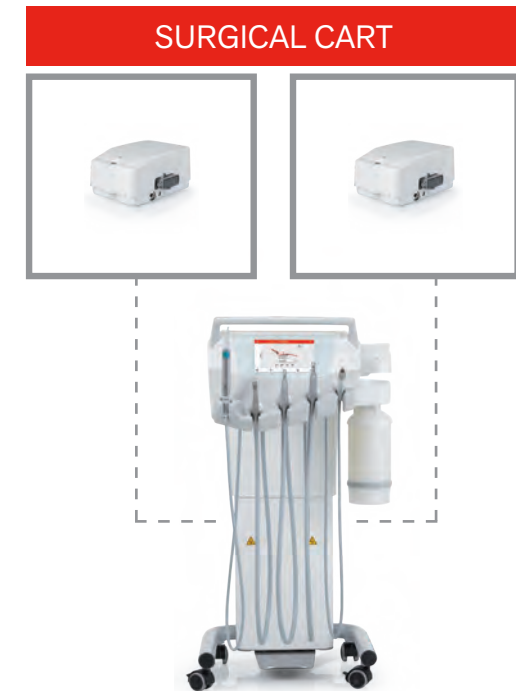

Lower investment.

By opting for the version with a quick connection box, the overall investment for a Cart and multiple connection boxes is significantly lower in terms of equipment and instruments.

What's more, all equipment maintenance costs are halved if one Cart replaces two.



Quick coupling.

No technician required: you can simply detach the Cart from its connection box and couple it to the other box in the surgery. Safe in every way, the box features a flap to protect the socket from dust, accidental impact or any external bio risks.

The connection has been designed to make operation easier and provide an extremely hard-wearing solution with effective additional safeguards.



Hygiene systems

HYGIENE

Materials suitable for frequent sanitization are employed to ensure a safe environment for medical team and patients alike. Moreover, being able to operate the

instruments and control the devices via the foot control minimises hand contact with the equipment.



FLUSHING provides a fast rinse of the spray circuits, eliminating any stagnant liquid from the tubing; its use is recommended every morning when the surgery opens.



S.H.S.
Independent spray feed. Works with distilled water to prevent limescale. Extremely useful where mains water is hard.



O.D.R.
As-standard mechanism that automatically emits an air jet to clean any residual liquids or solids from the handpiece after use.



CLEAN.
The Clean function disables control panel operation when the glass surface is being cleaned, thus preventing unwanted actuation of the controls.



Covers.
Practical disposable covers that protect the glass surfaces of the control panel.

Foot control

Three different ergonomic designs are available, each of which has a wireless version.

These allow activation of Chip Air/Water and micromotor rotation inversion.



WIRELESS

The advanced joystick gives dentists control over endodontic and implant treatment, minimising interaction with the console. It can be used to activate or deactivate the peristaltic pump, reverse micromotor rotation or proceed to the next stage of treatment (each stage has specific settings). All this helps improve hygiene. The wireless version makes Cart use more flexible, reduces space requirements and keeps the room clutter-free.

Anthos Connect

All products in the Anthos dental unit range are equipped with an integrated device that allows internet connection. A series of optional, remote services make surgery workflows more efficient. When linked to the Internet via Easy Check, the Cart can rely on a real-time troubleshooting and technical support service.



Using the instruments.
The dashboard lets users monitor how the integrated instrumentation is actually used, info on individual instrument work modes (Conservative, Endo) included. This helps estimate maintenance requirements or assess the need for upgrades on some machines.

REMOTE ASSISTANCE

